



***drive***



TRS160 Glideabout Commode

Instructions for use



## Introduction

Please read these instructions carefully prior to initial use. They contain important safety information and valuable tips for proper use and care.

The TRS160 Glideabout Commode is intended as an aid for showering and toileting for users with mobility difficulties. This chair is not intended to transport users, so should only be wheeled when unoccupied. The chair is designed for occasional or frequent indoor use.

It comes with a 5 litre bucket and lid, and can be wheeled over most conventional and disabled toilets. The device has a steel frame, vinyl cushion and backrest, polyurethane (PU) armrests and recess-free castors to prevent water trapping. The TRS160 commode supports users weighing up to 160 kg (25 stone).

If you have questions or need additional information, contact Drive DeVilbiss Healthcare Ltd or your approved supplier.

## Parts Description

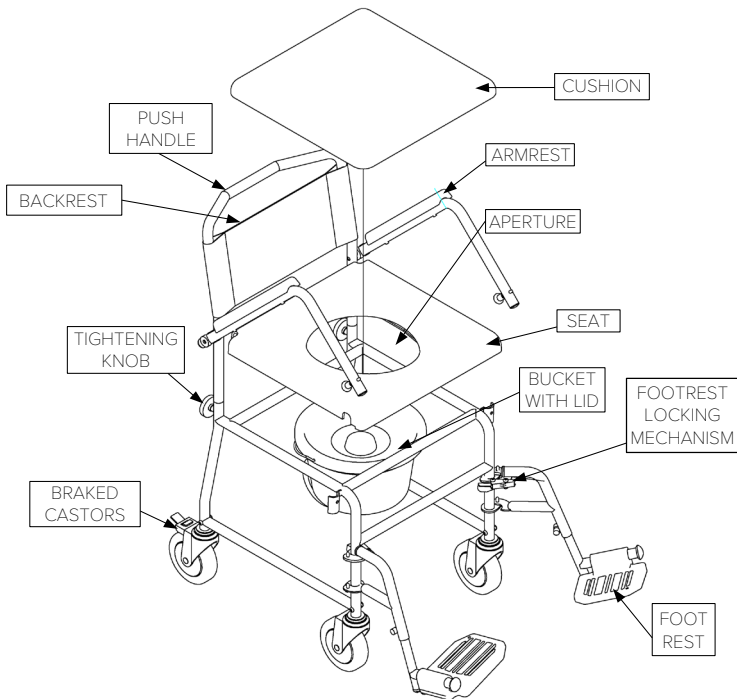

## Preparing for Use

These instructions should be read carefully before using the commode. This product does not have a service manual. Repairs and adjustments should be done by approved service personnel. Any adjustments must be made for each user.

A risk assessment must also be performed to assess suitability of the device for the user. This assessment should include, but not be limited to:

- Small adults (and children)
- Very active occupants
- Users who lack capacity
- Unauthorised access to the device

Attendants are responsible for determining that they are both mentally and physically capable of using the commode with minimal risk of harm.



**Maximum occupant mass** – Exceeding the limit marked on your device can damage the product and put users at risk of harm.



### **Before using the commode, read the safety notices below;**

- Check all components are secured before use.
- Only use on level ground. Do not use on steep or uneven terrain.
- The commode is only suitable for single occupancy when stationary. Do not use for patient transport.
- Brakes should always be applied when transferring or stationary.
- Be careful of clothing or body parts getting caught in pinch points, when rising from or lowering on to the commode, when moving the armrests or when removing the bucket.
- Keep the occupant's feet on footrests. Do not stand on footrests.
- Swing away the footrests before getting in or out of the chair. The user should always remove their feet from the footrests before swinging the footrests away.
- Maintain proper balance at all times. Users should not lean or move their centre of gravity out of the seating area or reach for items further than their arm's length.
- Keep away from heating sources, ignition sources and temperatures above 60°C for long periods (for example, a sauna) – risk of high surface temperatures or causing a fire.

# Assembly and Adjustment



## Warning

Ensure that fingers and objects do not get caught in any removable parts or pinch points during assembly or adjustment.

## Attaching the Backrest

Loosen the two knobs (1) on either side of the commode by turning anticlockwise.

Insert the backrest section (2) into the two receivers on the frame.

Secure the backrest by tightening the two knobs (1) by turning clockwise.

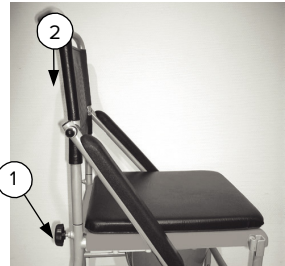

## Moving the Armrests

The armrests can be moved for side transfer, or locked in position when required.

To unlock, pull the locking knob (3) and swing each armrest downwards.

To lock, pull both armrests into position until they lock with an audible click. The locking pin (4) must be visible.

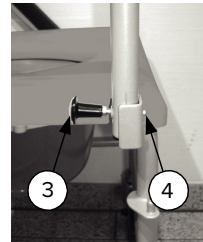

## Attaching the Footrests

Hang the footrests on the two pins located on the frame (5). Swing each footrest inwards until they lock in position with an audible click.

A heel strap can optionally be fastened around the footrests once attached.

To release, push the lever inwards (6) whilst pushing the footrests away.

Lift up the legrests to remove.

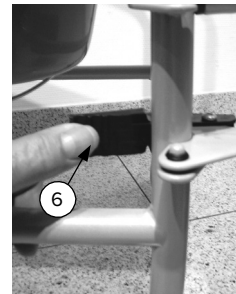
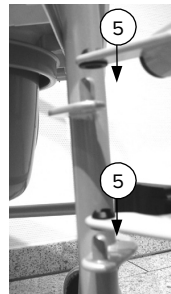

## Adjusting the Footrest Height

Remove the caps from the M8 nyloc nuts and loosen with an appropriate tool. Once loose, adjust to the required height for each user. Re-tighten to secure, then replace the caps.



# Using the Commode

## Transferring Users

Move the seats as close as possible to each other. Always engage the castor brakes and fold the footrests outwards.

If users need to be lifted, attendants are responsible for being suitably trained and competent to lift users with minimal risk of harm. Do not use the commode to transport users.

## Using the Castor Brakes

Press down on the lever (7) located above the wheel to apply the castor parking brake (as shown in the diagram).

To release the lock, press the other protruding tab (8) above the wheel with a foot.

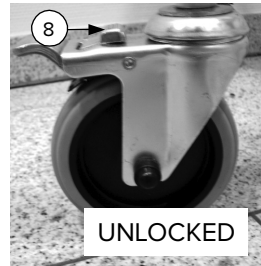

## Using the Bucket and Lid

The bucket and lid are accommodated underneath the plastic seat.

To add the bucket, slide underneath the seat from the back of the commode. Ensure that the bucket is secure on the two rails attached to the underneath of the seat.

To remove the bucket, slide the bucket from underneath the seat. Cover the bucket with the lid and carry the bucket securely using the handle to reduce the risk of spillages.



### Warning

Only move the bucket when the chair is empty to prevent trapping. Carefully dispose of the contents in a sluice or WC. Do not dispose in an open drain or sink as this can cause serious health risks.

## Frequently Asked Questions

- If the castors do not move easily, ensure the castor brakes are not engaged. Check for objects trapped in the castor.
- If the bucket is not secure, or tends to slide out, ensure the bucket is securely resting on the two rails underneath the seat and that the commode is on level ground. Ensure that only buckets supplied with the commode or approved for use are used.

## Care and Maintenance

Do not use a damaged or badly worn chair. Check routinely for any malfunctions or changes in performance. Contact Drive DeVilbiss Healthcare Ltd or your provider for spares, or to replace damaged or worn parts.

- Brakes and castors should be checked before each use, and at least once a month. All castors are solid, so do not require inflation.
- Keep the chair dust free and clean regularly (at least once a week) by hand, using a moist cloth and mild detergent. Spray castors and fasteners with a water dispersing agent. The chair should be disinfected between use with different users to avoid cross-contamination. The bucket should also be disinfected manually or in an autoclave after each use. Removable parts can be disassembled to aid cleaning and disinfection. Avoid neat bleach, high-dose chlorine, vinegar-based or abrasive cleaners. Wipe and leave to fully dry before reuse.
- Check screws, joints and upholstery regularly. Adjust or replace, if needed.
- Drive DeVilbiss Healthcare Ltd recommend that an approved service engineer services the device annually. If the device is subject to heavy use or used in a multi-user environment, service more frequently. Repair, replace, adjust and/or lubricate these parts if required:
  - Joints and fasteners
  - Castors and brakes
  - Footrest locking mechanism
  - Bucket and lid
  - Seat, back and arm pads
- The device has an estimated service life of 5 years in a single-user domestic environment, when maintained in line with the manufacturer's recommendations. In a multi-user environment (such as a nursing home or hospital) the service life may be reduced.
- When the product has reached the end of its useful life, follow local recycling and disposal policies.

## Storage

Store the commode in a dry environment, away from direct sunlight with the castor brakes on. The chair (and bucket) must be cleaned before storing, using the instructions above.

Your wheeled commode may require carrying if no elevators or ramps are available. Attendants are responsible for being suitably trained and competent to lift the commode with minimal risk of harm. Adopt the latest health and safety recommendations and do not carry using the handles or removable sections.

## Specification

Model	TRS160
Overall width	56 cm (22")
Overall length without footrests	63 cm (25")
Overall length with footrests	95 cm (37.5")
Overall height	97 cm (38")
Backrest height	38 cm (15")
Seat depth	42.5 cm (16.5")
Seat height	52 cm (20.5")
Height between floor and seat	43 cm (17")
Seat width	44 cm (17.5")
Lateral stability	15°
Forward/rearward stability	11°
Bucket capacity	5 litres (1 gallon)
Product weight	14.4 kg (31.7 lb)
Maximum occupant mass	160 kg (25 st)

## Warranty

Your Drive branded product is warranted to be free of defects in materials and workmanship for two years from date of purchase. This device was built to exacting standards and carefully inspected prior to shipment. This warranty is an expression of our confidence in the materials and workmanship of our products and our assurance to the customer.

In the event of a defect covered by this warranty, we will at our option supply parts or replace the device. This warranty does not cover device failure due to owner misuse or negligence, or normal wear and tear. The warranty does not extend to non-durable components, such as castors, brakes and handles, which are subject to normal wear and need periodic replacement.

If you have any queries or require full warranty conditions, please contact your provider.

## Support

For more information, or assistance with use and maintenance, please contact your provider. Users with visual, reading or cognitive disabilities should seek advice from their provider for an appropriate format. For the latest version of this document, contact Drive DeVilbiss Healthcare Ltd using the details below, or check our website.

### **Drive DeVilbiss Healthcare Ltd**

Sidhil Business Park,  
Holmfield, Halifax,  
West Yorkshire,  
HX2 9TN,  
Great Britain

[info@drivedevilbiss.co.uk](mailto:info@drivedevilbiss.co.uk)  
[www.drivedevilbiss.co.uk](http://www.drivedevilbiss.co.uk)

Customer Service

Tel: +44 (0) 845 0600 333

Fax: +44 (0) 845 0600 334

Spares

Tel: +44 (0)1274 475125

### **Drive DeVilbiss Sidhil Ltd**

4 Trench Road,  
Mallusk,  
Newtownabbey,  
BT36 4TY,  
Northern Ireland





## TRS 130 and TRS 160 PARTS LIST

Document issued 08/22



Item no.	Article no.	Description	Quantity
1	530100092	Backrest for TRS 130 / 160	1
2	530100020	Seat support/seat pad for TRS 130 / 160	1
3	530100093	Star handle screw for TRS 130 / 160 + for crutch holder	1
4	530100098	Spring button for arm support for TRS 130-160-NEW-	1
5	530100090	Bucket with lid for: TSG (SN: 2A...), TRS 130, TRS160, TS 130, DuoMotion range 2 and 3, TRS 200 XXL, Aston	1
6	530100081	Wheel with parking brake for TRS 130 / TRS 160 / trs 200 XXL up to SN: 4S2004300000	1
7	530100080	Wheel without parking brake for TRS 130 / TRS 160 / TRS 200 XXL up to SN: 4S2004300000	1
8	530100095	Footplate for TRS 130 / TRS 160	1
9	530100003	Footrests for TRS 130 / TRS 160 from serial no. 00001/35/09	1
10	530100096	Cover plugs on the tube end for TRS 130 / TRS 160 legrests	1
11	530100114	Heel loop for TRS 130 / TRS 160	1
12	530100099	Clip bearing on footrest TRS 130 / TRS 160	1
13	530100001	TRS 130 / TRS 160 toilet seat (SN: 2F...)	1
13	530100006	Seat plate grey for TRS 130 / TRS 160 (SN 7K)	1
14	530100050	Armrest frame for TRS 130 / TRS 160	1
15	530100094	Armpad for TRS 130 / TRS 160	1
o.Abb	530100090A	Bucket with lid for TRS 130 (range 1) / TRS 160	1
o.Abb.	530100060	Footrest left + right swingaway for TRS 130 / TRS 160 chrome	1
o.Abb.	530100082	TRS 130 / TRS 160 wheel set/alternative to 2 cm	1